

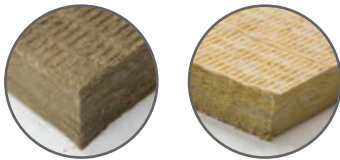



Commercial Insulation

Thermafiber® VersaBoard™

- + Excellent Thermal Performance (R-Value up to 4.2 per inch)
- + Exceptional sound and noise absorption
- + Fire resistant to temperatures above 2,000°F (1,093°C)
- + Easy to fabricate
- + Conserves energy, reduces Greenhouse gas and carbon emissions
- + Available in dark and regular colored fibers



VersaBoard™ is ideal for parking garage under decking. It is engineered to control sound and provide energy saving thermal protection.



LEED® Green Building Credits

Energy & Atmosphere	Materials & Resources	Indoor Environmental Quality	Innovation in Design
1	2.1, 2.2 3.1, 3.2 4.1, 4.2 5.1, 5.2	3.1, 3.2 9	1

Contributes to 33 LEED® credits across 4 categories.

Up to 90% Recycled Content

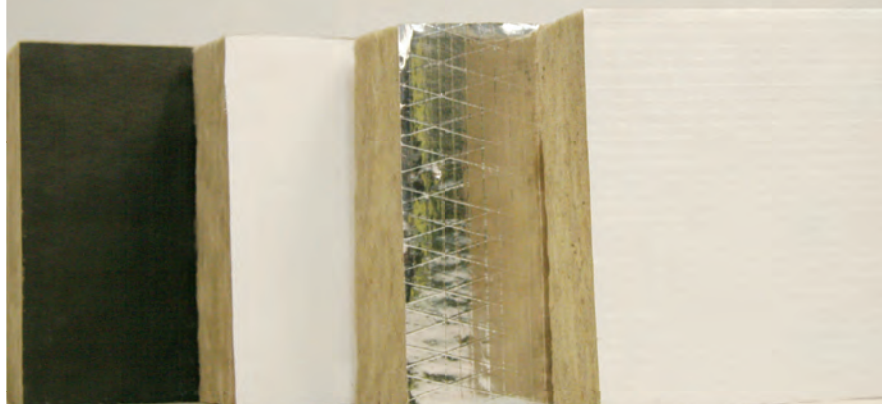

VersaBoard™ can be manufactured with many different facing options.

Thermafiber® VersaBoard™

Description:

THERMAFIBER VersaBoard provides the best possible combination of fire protection, sound control, thermal insulation, and energy conservation for various commercial construction applications. These products are ideal for parking garage under decking, mechanical rooms, and other areas where insulation is required. These products are engineered to repel moisture and can be an exposed interior surface. VersaBoard is not listed by UL for use in perimeter fire containment systems.

Product Options:

Product	Foil Facing	ASJ & Other Facings	Dark Fiber
VersaBoard 35	≥ 2 ½"	≥ 3 ½"	✓
VersaBoard 40	≥ 2"	≥ 3"	✓
VersaBoard 60	≥ 1 ½"	≥ 2"	✓
VersaBoard 80	≥ 1"	≥ 1 ½"	✓

Recycled Content Options¹:

Special "Green" Fiber	90%
Dark Fiber.....	84%
EPA Choice Fiber (US Government Buildings).....	75%
Standard Fiber.....	70%

¹Recycled content options other than Standard must be specified at time of order.

Installation:

Thermafiber recommends mechanical attachment of VersaBoard products. Standard insulation pins and washers are recommended.

Standard Sizes:

Product	Thickness*	Widths**	Lengths**
VersaBoard 35	1 ½" – 6"	24", 36"	48", 60"
VersaBoard 40, 60	1"-6"	24", 36"	48", 60"
VersaBoard 80	1"-5"	24", 36"	48", 60"
Tolerances	+1/4" - 1/8"	±1/8"	±1/2"

*Thicknesses are available in ½" increments. **Custom sizes are available upon request.

Technical Data:

Product Designation	Actual Density	Tested to ASTM E 84					
		Tested to ASTM C 518		Unfaced		Foil Faced	
		"k" @ 75° [24°C] BTU. in/hr.sq. ft. °F	"R" value per inch of thickness***	Flame Spread	Smoke Developed	Flame Spread	Smoke Developed
VersaBoard 35	3.5 pcf	0.25	4.0	0	0	25	0
VersaBoard 40	4.0 pcf	0.24	4.2	0	0	25	0
VersaBoard 60	6.0 pcf	0.24	4.2	0	0	25	0
VersaBoard 80	8.0 pcf	0.24	4.2	0	0	25	0

***R = thickness divided by 'k'

Standards Compliance:

ASTM C 665	Non-Corrosive Type I (unfaced material), Type II (Black & White Mat, ASJ), Type III (foil)
ASTM C 612	VersaBoard 30 1A; VersaBoard 40 1A, 1B, II
ASTM C 612	VersaBoard 60 & 80 1A, 1B, II, III
ASTM E 136	Rated Non-combustible per NFPA Standard 220
ASTM E 96	ASJ & foil faced, 0.02 perms as tested
ASTM C 1104	Absorption less than 1% by volume
ASTM C 356	Linear shrinkage <2% @ 1200° F (650°C)

Thermafiber Insolutions™:

Thermafiber offers industry leading technical and engineering assistance to architects, specifiers, and contractors. These services include CAD drawings, engineering judgments, LEED® Credit Information, product recommendations, and customized products. Contact our technical services department at 1-888-834-2371, or email technicalservices@thermafiber.com.

For Further Information:

For additional information about these or other Thermafiber products contact us at 1-888-834-2371 or visit our website www.thermafiber.com.

Notice:

THERMAFIBER, Inc. shall not be liable for incidental and consequential damages, directly or indirectly sustained, nor for any loss caused by application of these goods not in accordance with current printed instructions or for other than the intended use. THERMAFIBER liability is expressly limited to replacement of defective goods. Any claim shall be deemed waived unless made in writing within thirty (30) days from date it was or reasonably should have been discovered.

Submittal Approvals:

Job Name	
Contractor	Date

